

ENERKIT BASIC CONVERSION SYSTEM

- The EnerKit Basic is a unique, compact propane carburetor allowing all gasoline small engines to run on cleaner burning LPG while maintaining superior performance.
- EnerKit Basic provides the smartest alternative fuel solution, designed according to the highest standards.
- Reduce Greenhouse Gas emissions (GHG) by more than 15% and reduce Carbon Monoxide by more than 40% when compared to gasoline.
- Significant fuel savings-up to 40% when compared to gasoline.
- Retain performance and require less maintenance.
- Our commitment is to promote a healthier, greener way of life, be it at home or outdoors thanks to LPG and the EnerKit Basic.

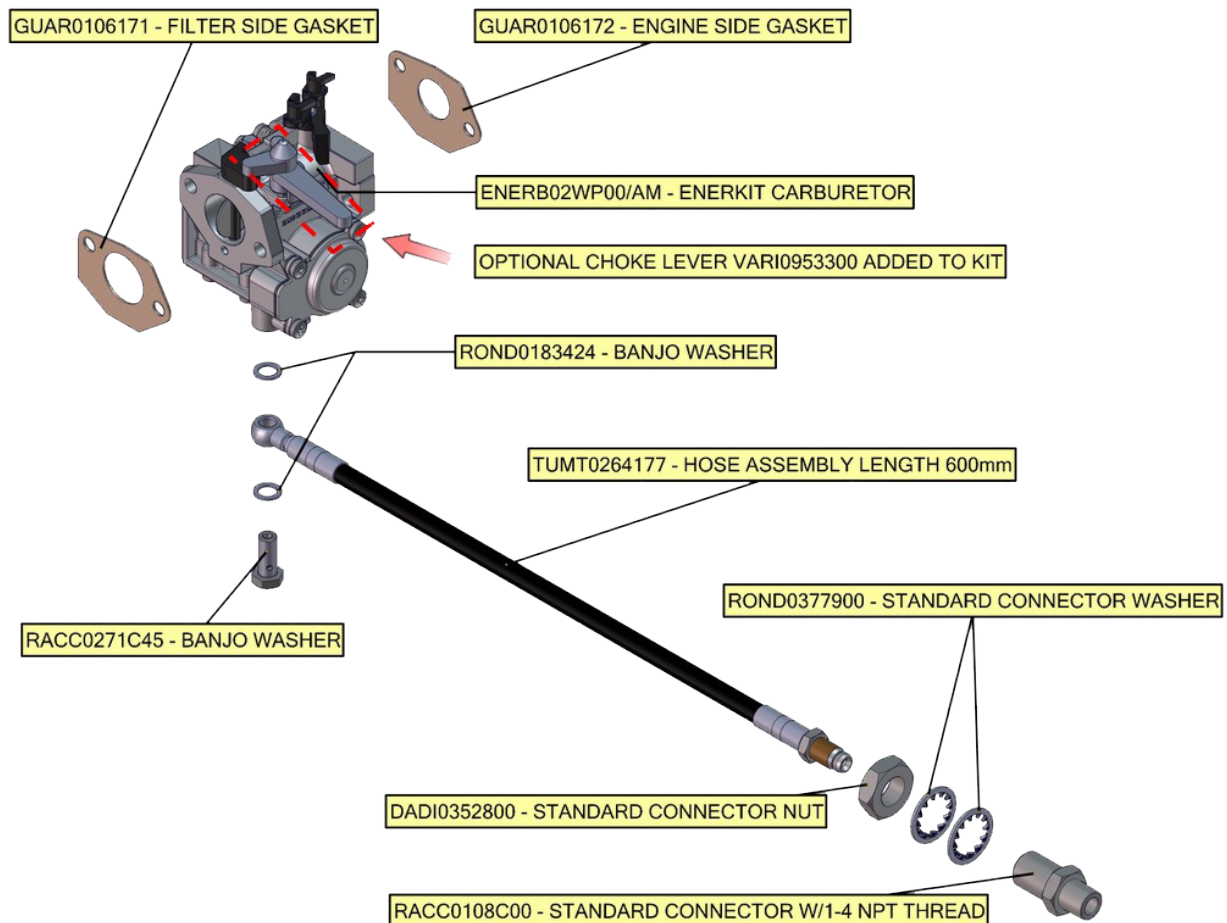

ENGINE COMPATIBILITY LIST

ENGINE TYPE	HONDA	LIFAN	ENERKIT TYPE FACE MOUNT	ENERKIT TYPE TOP MOUNT
HORIZONTAL SHAFT	GX120	LF160F-AQ	2S-LIFAN200FM	2SLIFAN200TM
HORIZONTAL SHAFT	GX160	LF168F2-BQ- 5.5hp (LIFAN ONLY HAS 6.5hp)	2S-LIFAN200FM	2S-LIFAN200TM
HORIZONTAL SHAFT	GX200	LF168F2-BQ	2S-LIFAN200FM	2S-LIFAN200TM
HORIZONTAL SHAFT	GX240	LF177F-BQ - 8hp (LIFAN ONLY HAS 9hp)	2S-LIFAN390FM	2S-LIFAN390TM
HORIZONTAL SHAFT	GX270	LF177F-BQ	2S-LIFAN390FM	2S-LIFAN390TM
HORIZONTAL SHAFT	GX340	LF188F-BQ	2S-LIFAN390FM	2S-LIFAN390TM
HORIZONTAL SHAFT	GX390	LF188F-BQ	2S-LIFAN390FM	2S-LIFAN390TM

**If engine is not listed, please contact your local salesperson.*